



ARMSCOR

MODEL 1500

USER'S MANUAL

WARNING:

READ THE INSTRUCTIONS AND SAFETY PRECAUTIONS IN THIS MANUAL CAREFULLY BEFORE USING THIS FIREARM.

DISCHARGING FIREARMS IN POORLY VENTILATED AREAS, CLEANING FIREARMS OR HANDLING AMMUNITION MAY RESULT IN EXPOSURE TO LEAD AND OTHER SUBSTANCES KNOWN TO THE STATE OF CALIFORNIA TO CAUSE BIRTH DEFECTS, REPRODUCTIVE HARM AND OTHER SERIOUS PHYSICAL INJURY. HAVE ADEQUATE VENTILATION AT ALL TIMES. WASH YOUR HANDS THOROUGHLY AFTER EXPOSURE.

OPERATING INSTRUCTIONS AND CARE

This rifle is packed with detach gunstock. Insert receiver bolt, before assembly, remove all traces of oil from barrel bore.

ASSEMBLY

* TO ATTACH BARREL- RECEIVER AND GUNSTOCK

Position barrel- receiver assembly on gunstock. Insert receiver take down screw thru the gunstock. Center the barrel- receiver assembly until the barrel –receiver take down screw freely threads into the mating hole of the receiver. Tighten screw.

* TO INSERT BOLT ASSEMBLY INTO RECEIVER

Cock the bolt assembly by gripping the bolt firmly and rotating the cocking cam counter clockwise. Move trigger block lever to “F” position. Depress trigger.

- Align the lug underneath the bolt assembly with the receiver track. Slide the cocked bolt assembly into the receiver. Push fully forward and turn cocking cam clock-wise until lugs properly seated. Release trigger.
- * TO LOAD MAGAZINE BOX
Hold magazine firmly in one hand. With the other hand, position cartridge over magazine lip just forward of notch. Insert cartridge head under ears at rear of magazine. Repeat until five cartridges are loaded.
 - * TO BLOCK TRIGGER
Move trigger block lever to “S” position until latch clicks into place. This locks trigger.
 - * TO ATTACH MAGAZINE BOX
Position magazine open end up and ears rearward. Insert magazine into the opening forward of the trigger guard. Push magazine inward until it engages the magazine lock.
 - * TO OPEN ACTION
Hold bolt handle and rotate cocking cam counter clockwise. As soon as the lugs clear the lug seat, pull bolt handle fully rearwards.
 - * TO CLOSE ACTION
Push bolt handle fully forward and rotate cocking cam clockwise until lugs are properly seated.
 - * TO FIRE
Be sure the rifle is pointed at target. With action closed, move trigger block latch to “F” position. Pull trigger. To repeat, open and close the action. The discharge shell will be ejected and a new cartridge will be fed into the chamber. Pull the trigger. Repeat process as desired until magazine is empty.
 - * TO LOAD FOR SINGLE SHOT

Open action. Insert cartridge directly into chamber with empty magazine in place.

CARE OF RIFLE

* FOR SHORT STORAGE

After firing, swab bore with clean cloth patch wet with approved cleaning solvent. Wipe dry. Apply light coat of oil on barrel bore, cocking cam, bolt and other metal surfaces to keep free of rust.

* FOR LONG STORAGE

After firing, swab bore with clean cloth patch wet with approved cleaning solvent. Wipe dry. Apply a good grade of gun grease or gun oil on barrel bore, cocking cam, bolt and other metal surfaces.

Before firing after storage, remove all traces of gun grease or gun oil from barrel bore.

Check that bore is free of any obstruction! Obstruction will block passage of bullets and may cause injury to barrel or person.

PRODUCT SPECIFICATIONS:

Model	M1500
Caliber	22 MRF
Action	Bolt Action
Sights	Bead Ramp Front Sight, Rear Sight Block with Windage and Elevation Adjustment
Barrel Length	22.50 inches
Magazine Capacity	5 Rounds
Overall Length	41.125 inches
Trigger Pull	4.0 – 6.0 Lbs
Length of Pull	14.00 inches
Drop at Comb	1.50 inches
Drop at Heel	2.00 inches
Weight (empty)	6.5 lbs (Approx)

Finish	Blued
Barrel	Ordnance Steel, Precision Rifled with Six (6) Grooves Right Hand Twist.
Stock	Natural finish Philippine Wood stock, Monte Carlo Style with Plastic Butt Pad Without Check Piece, Checkering and Grip Cap.

PART NAME	PART NUMBER
-----------	-------------

A- BARREL- RECEIVER ASSEMBLY

Barrel	15001
Barrel Receiver Cross Pin	15002
Ejector	15003
Ejector Screw	15004
Front Sight Ramp	15005
Front Sight Hold Down Screw	15006
Rear Sight Base	15007
Rear Sight Elevating Ramp	15008
Rear Sight Elevating Ramp Stop Pin	15008A
Rear Sight Elevating Ramp Bearing	15008B
Rear Sight Elevating Ramp Bearing Spring	15008C
Rear Sight Peep Block	15009
Rear Sight Peep Block Pin	15009A
Rear Sight Peep Block Windage Screw	15009B
Rear Sight Peep Block windage Spring	15010
Receiver	15011
Receiver Take Down Screw	15012
Receiver Take Down Screw Washer	15013

B- BOLT ASSEMBLY

Bolt	15014
Cocking Cam	15015
Cocking Cam Stud	15017

Cocking Cam Stud Retainer	15018
Cocking Cam Stud Retainer Spring	15019
Extractor Left Hand	15020
Extractor Right Hand	15021
Extractor Plunger	15022
Extractor Spring	15023
Firing Pin	15024
Firing Pin Spring	15025
Firing Pin Spring Retainer Pin	15026
Firing Pin Spring Follower	15027
Firing Pin Cross Pin	15028
Hammer	15029

C- TRIGGER HOUSING ASSEMBLY

Magazine Catch with Insert	15030
Magazine Catch Pivot Pin	15031
Magazine Catch Stop Pin	15032
Safety Latch	15033
Safety Latch Bearing	15034
Safety Latch Bearing Spring	15035
Safety Latch Pivot Pin	15036
Safety Latch Button	15037
Sear	15038
Sear Pivot Pin	15039
Sear Spring	15040
Sear Stop Pin	15041
Trigger	15042
Trigger Pivot Pin	15043
Trigger Spring	15044
Trigger Stop Pin	15045
Trigger Housing	15046

Trigger Housing Hold Down Screw (front)	15047
Trigger Housing Hold Down Screw (rear)	15047

D- MAGAZINE BOX ASSEMBLY

Magazine Box	15049
Magazine Spring	15050
Magazine Spring Follower	15051
Magazine Spring Retainer	15052
Magazine Spring Retainer Cross Pin	15053

E- GUNSTOCK ASSEMBLY

Butt Pad (plastic)	15054
Butt Pad Retainer Screws	15055
Gun Stock	15056
Grip Plate	15057
Grip Plate Retainer Screw	15058

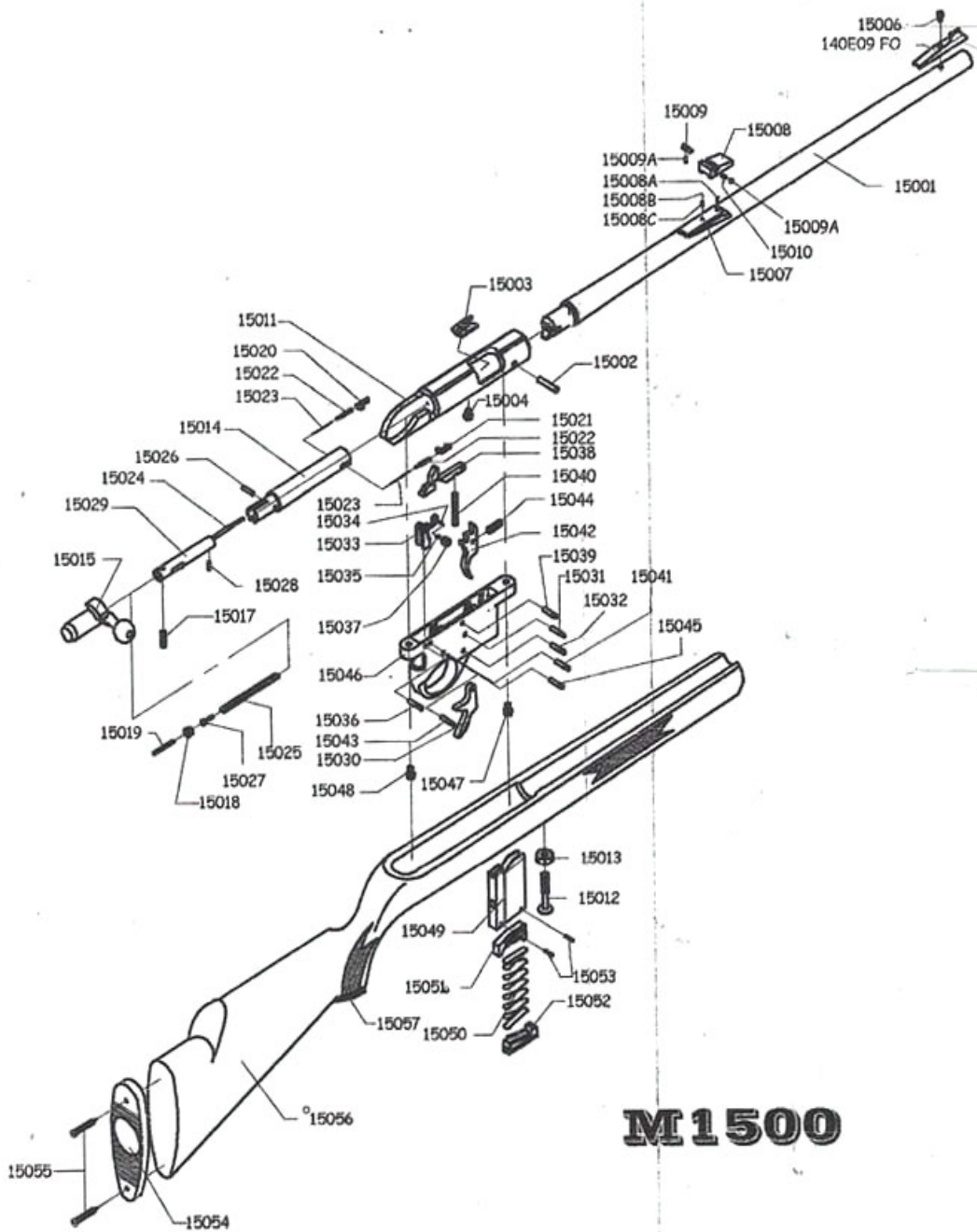

M1500